





### Edgewater Park General Notes

- Develop Landscape Master Plan to guide long term plantings
- Supplement bluff forest and vegetation
- Plant next-generation legacy trees
- Expand sand dunes as possible
- Add trees to parking lots
- With partners, explore long-term potential to add shoreline buffer habitat areas
- Continue to implement green infrastructure overlay plan
- Promote non-vehicular access, particularly for events (single occupant or any)
- Consider charging for event parking
- Improve awareness of transit and bike and pedestrian access
- Monitor safety improvements made by ODOT along Edgewater Parkway and Cleveland Lakefront Bikeway

### Pier Concession and Restrooms

- Renovate restrooms
- Phase out concessions as marina comes online
- Improve bike and pedestrian circulation

### Edgewater Pier

- Enhance existing pier
- Maintain fishing
- Consider expansion

### Parking and Traffic Flow

- Consider parking management efforts in the main lot to encourage carpooling, biking, walking or transit
- Continue traffic management at roundabout
- Add preferred parking for carpool vehicles and EV charging stations
- Consider limiting areas accessible by dockless scooters

### Edgewater Beach

- Advocate with partners to supplement breakwall
- Increase dunes for sand control
- Expand volleyball league play
- Add terraced seating along west shore
- Add water-based play to provide feature for days with poor beach conditions

— All Purpose Trail

- - - Other Adjacent Trails

- - - Other CM Trails

••• Proposed Trails (Various Entities)

— Proposed Boardwalk

||| Land Protection

Water

Wetlands

Other Parks

RTA RTA Stop

K Kayak Launch

### Edgewater Marina

- Reconfigure to expand public access and use
- Include park operations summer satellite base
- Modify intersection and make area more inviting

NEORS  
Westerly  
Wastewater  
Treatment

Port of  
Cleveland

Edgewater Marina

Whiskey Island Connector Trails (2020)

Whiskey Island Dr

Father Caruso Dr

Battery  
Park

W.73rd St

W.70th St

W.65th St



Lakefront Reservation  
Lower Edgewater Park  
Master Plan  
December 2019



0 100 200  
Scale in feet

### Wayfinding

- Continue to partner to improve area signage for park connections



**Wendy Park General Notes**

- With partners, explore long-term potential to add shoreline buffer and habitat areas
- Enhance tree plantings and habitat areas, particularly for migration and pollinators
- Consider mechanism to curtail access when parking is at capacity

**Former Coast Guard Station**

- Pursue long term use agreement
- Add water taxi stop
- Pursue causeway repairs including new railings with partners
- Continue to work with partners to expand youth programming
- Consider tower access during summer weekends
- Add buoys and enforce safe/slow zone

**Volleyball Courts**

- Expand to Edgewater Beach

**Whiskey Island Marina**

- Work towards increasing public access to water and consolidating boat storage

**Whiskey Island Connector Trail**

- Completed by 2021
- Includes pathway lighting

**Restroom and Shelter**

- Construct new restroom and small shelter in this area

**Marina, Restaurant and Parking**

- Develop strategy for structures and parking

**Site Improvements**

- Consider overlook and terraced seating with stage platform

**Trail Connections**

- Trail links to Edgewater Park, Rivergate Park and surrounding neighborhoods to be complete by 2021
- Manage trail access constraints on Willow Street lift bridge

— All Purpose Trail

- - - Other Adjacent Trails

- - - Other CM Trails

••• Proposed Trails (Various Entities)

— Proposed Boardwalk

||| Land Protection

Water

Wetlands

Other Parks

Habitat Areas

Proposed Water Taxi

Kayak Launch

Lake Erie

Shipping Channel

Cuyahoga River

Shipping Channel

Edgewater Way

Willow St

Elm Ave

River Rd

Whiskey Island Marina

Port of Cleveland



Lakefront Reservation  
Wendy Park Master Plan

December 2019

0 100 200  
Scale in feet





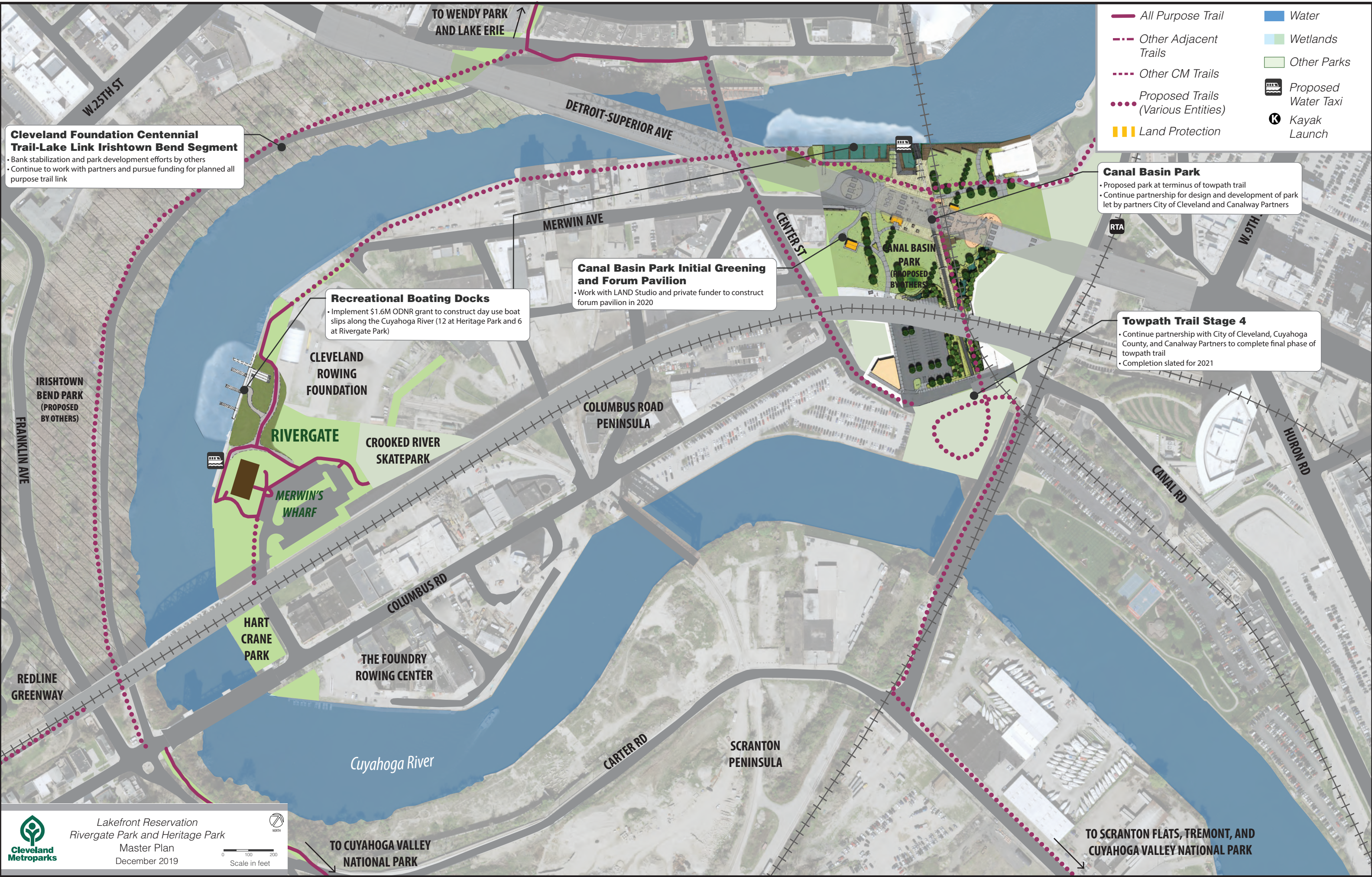

**Cleveland Foundation Centennial Trail-Lake Link Irishtown Bend Segment**

- Bank stabilization and park development efforts by others
- Continue to work with partners and pursue funding for planned all purpose trail link

**Recreational Boating Docks**

- Implement \$1.6M ODNR grant to construct day use boat slips along the Cuyahoga River (12 at Heritage Park and 6 at Rivergate Park)

**Canal Basin Park Initial Greening and Forum Pavilion**

- Work with LAND Studio and private funder to construct forum pavilion in 2020

**Canal Basin Park**

- Proposed park at terminus of towpath trail
- Continue partnership for design and development of park let by partners City of Cleveland and Canalway Partners

**Towpath Trail Stage 4**

- Continue partnership with City of Cleveland, Cuyahoga County, and Canalway Partners to complete final phase of towpath trail
- Completion slated for 2021



**Lakefront Opportunities and National Fish and Wildlife Foundation Planning Grant for Cleveland Harbor Eastern Embayment (CHEERS)**

- Study lakefront from eastern edge of Burke Lakefront Airport to Cleveland Lakefront Nature Preserve
- Study long-term options for park expansion and improved circulation
- Work with partners to address bike, pedestrian and transit and improve equitable park access
- Study opportunities to provide wetland habitat and expand land area at E.72nd for increased water-based recreation and education
- Potential waterfront center site
- Expanded breakwall to allow sheltered bay for paddle sports and youth programs

Lake Erie

Shipping Channel

- |                                    |                       |
|------------------------------------|-----------------------|
| All Purpose Trail (APT)            | Water                 |
| Other Adjacent Trails              | Shoreline Enhancement |
| Other CM Trails                    | Wetlands              |
| Proposed Trails (Various Entities) | Other Parks           |
| Proposed Boardwalk                 | Water Taxi            |
| Land Protection                    | Kayak Launch          |

**New Plaza**

- Create new gathering space overlooking water
- Provide fire pit, seating and small water feature
- Link to restaurant area with path/boardwalk

**Shoreline Improvements**

- Pursue plantings along edge of water. Develop and plant submerged shelves to increase habitat
- Add kayak access

**Improve Access**

- Reduce drive pavement
- Add accessible path to waterfront platforms and connect to new plaza

**Restroom**

- Renovate; remove excess roof structure
- Consider rooftop viewing deck

**Western Dock**

- Activate with public programming in partnership with others

**West Edge**

- Create shoreline wetland at inlet
- Develop and manage prairie habitat

**Cleveland Lakefront Bikeway**

- Improve wayfinding
- Enhance safety at roadway crossings
- Link to west and downtown along North and South Marginal Roads

**Waterfront Improvements**

- Study ADA access and fishing opportunities
- Add shoreline wetlands to increase habitat and mitigate shoreline wave action
- Add boardwalk feature as part of wetland development
- Work with partners to pursue outside funding for multiple improvements

Overlook with Bike Parking and Swing

**Restaurant, Concession and Patio**

- Consider relocating concession
- Improve building entry and reorganize parking
- Enhance patio with plantings
- Consider elevated structure to provide views over breakwater to lake

**I-90**

- Along with community partners, explore recommendations for long-term safety, resilience, and alignment improvements

**Former First Energy Site**

- Work with partners to seek highest and best use of lakefront, including additional public park space



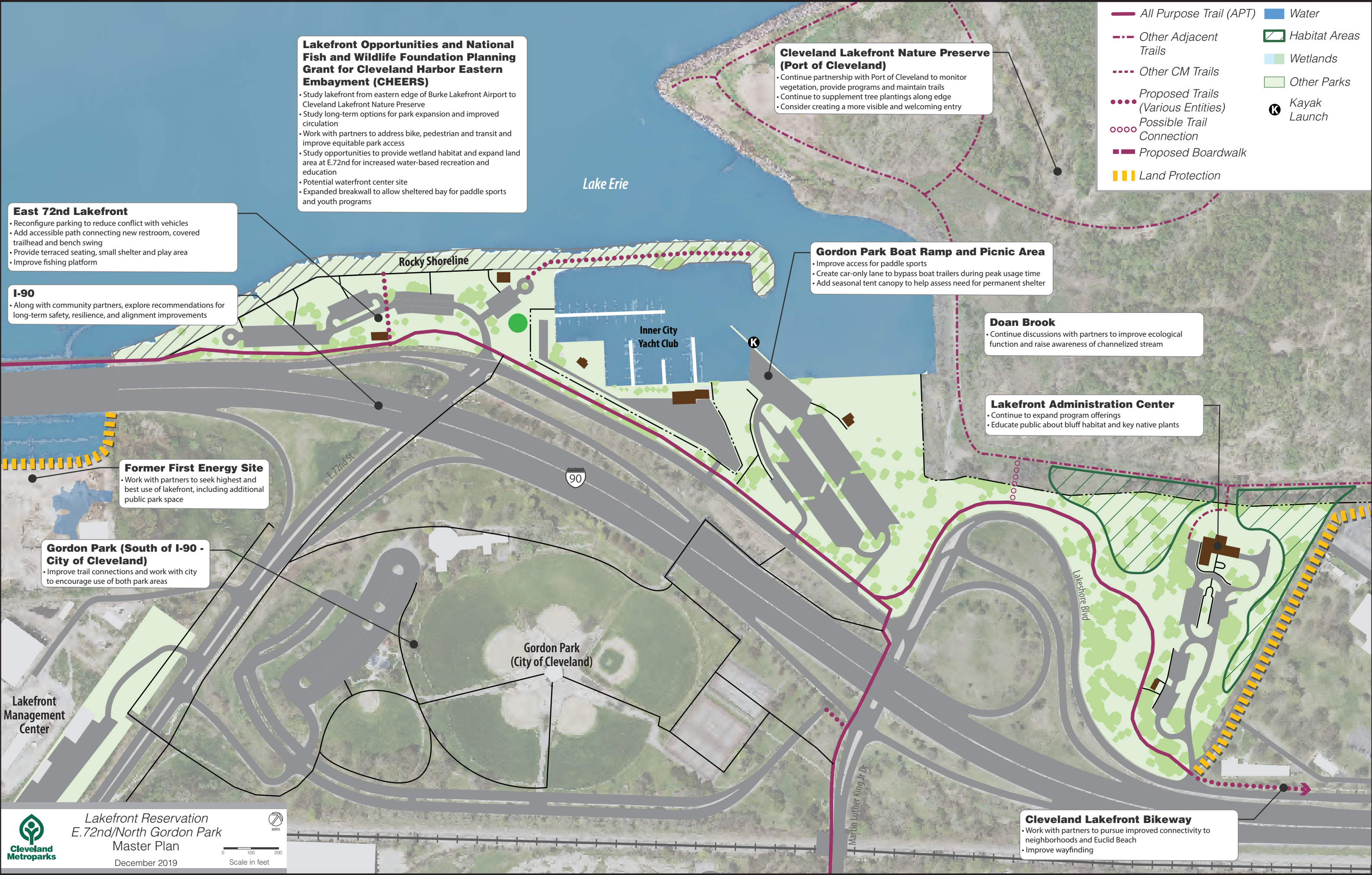

**Lakefront Opportunities and National Fish and Wildlife Foundation Planning Grant for Cleveland Harbor Eastern Embayment (CHEERS)**

- Study lakefront from eastern edge of Burke Lakefront Airport to Cleveland Lakefront Nature Preserve
- Study long-term options for park expansion and improved circulation
- Work with partners to address bike, pedestrian and transit and improve equitable park access
- Study opportunities to provide wetland habitat and expand land area at E.72nd for increased water-based recreation and education
- Potential waterfront center site
- Expanded breakwall to allow sheltered bay for paddle sports and youth programs

**East 72nd Lakefront**

- Reconfigure parking to reduce conflict with vehicles
- Add accessible path connecting new restroom, covered trailhead and bench swing
- Provide terraced seating, small shelter and play area
- Improve fishing platform

**I-90**

- Along with community partners, explore recommendations for long-term safety, resilience, and alignment improvements

**Rocky Shoreline**

**Inner City Yacht Club**

K

**Cleveland Lakefront Nature Preserve (Port of Cleveland)**

- Continue partnership with Port of Cleveland to monitor vegetation, provide programs and maintain trails
- Continue to supplement tree plantings along edge
- Consider creating a more visible and welcoming entry

**Gordon Park Boat Ramp and Picnic Area**

- Improve access for paddle sports
- Create car-only lane to bypass boat trailers during peak usage time
- Add seasonal tent canopy to help assess need for permanent shelter

**Doan Brook**

- Continue discussions with partners to improve ecological function and raise awareness of channelized stream

**Lakefront Administration Center**

- Continue to expand program offerings
- Educate public about bluff habitat and key native plants

**Former First Energy Site**

- Work with partners to seek highest and best use of lakefront, including additional public park space

**Gordon Park (South of I-90 - City of Cleveland)**

- Improve trail connections and work with city to encourage use of both park areas

**Gordon Park (City of Cleveland)**

**Lakefront Management Center**

**Cleveland Lakefront Bikeway**

- Work with partners to pursue improved connectivity to neighborhoods and Euclid Beach
- Improve wayfinding



Lakefront Reservation  
E.72nd/North Gordon Park  
Master Plan

December 2019

Scale in feet  
0 100 200



