

BROOKSIDE RESERVATION & ZOO

PARK PLAN

SEPT 2025

- BROOKSIDE OVERALL**
- Study circulation and improve wayfinding to Zoo and park
 - Improve brand recognition of Cleveland Metroparks at Brookside facilities
 - Improve coordination with area parks and community open space
 - Secure adjacent land protection opportunities; discuss internal opportunities
 - Continue to implement green infrastructure strategies to mitigate impervious surfaces

- BROOKSIDE PLAY FIELDS & PARKING**
- Optimize for informal use along with sports events, zoo overflow parking, and Brookside events

- BROOKSIDE VALLEY EVENT SITE**
- See Upland Area note re. proposed trail between the Event Site and Meadow Ridge overlook will improve connectivity, including access to existing vernal pools for programs
 - Consider enclosed facility for year-round use

- BIG CREEK CORRIDOR**
- Consider partnering to pursue upstream stormwater storage to reduce flood intensity

- JOHN NAGY BLVD**
- Add trailhead amenities and play area, fitness equipment, and signage in cooperation with natural resource restoration efforts in the area
 - Remove roundabout and create an intersection with three stop signs
 - Improve bike and pedestrian connections along Ridge Road

- CONNECTIONS TO WEST**
- Explore connections to Big Creek Reservation and other public open space, including Brooklyn's Kingdom Trail
 - Add wayfinding elements along Brookside Drive to enhance neighborhood/park/St. Thomas More/Brooklyn Community Center connections

- BROOKSIDE BALL FIELDS**
- Investigate options to relocate city forestry operations
 - Coordinate pending Northeast Ohio Regional Sewer District project construction access and impacts to park along with proposed leave-behind conditions
 - Renovate trails sections on the hill
 - Add a segment of paved trail along the toe of the bluff and behind the ball diamonds to create a loop
 - Consider playground improvements and potential field conversions to turf

- MEADOW RIDGE PICNIC AREA**
- Upgrade play equipment
 - Add flush restroom

- UPLAND AREA & OVERLOOK**
- Add stairs connecting upland overlook area to Brookside Event Center. Include a wheeling ramp to facilitate walking bicycles up or down the stairs and promote as part of Brookside's fitness programs. Provide trail maps along Fulton and in the valley
 - Maintain buffer along zoo perimeter

- NEIGHBORHOOD CONNECTIONS**
- Add Cleveland Metroparks trailhead signage at trail from Muriel and 38th St. to Wildlife Way
 - Explore opportunities with Estabrook Recreation Center/ Cleveland programs

- HISTORIC BROOKSIDE PARK STADIUM**
- Increase public awareness of historic use through programs / events and interpretive signage
 - Consider re-activating baseball field

- HISTORIC UNDERPASS**
- Highlight Stinchcomb's involvement in the stone underpass with an interpretive sign

- CLEVELAND METROPARKS ZOO**
- Improve connections into the Zoo for transit passengers arriving along Fulton Parkway or Pearl Road. Consider adding wayfinding and explore microtransit or e-bike options.
 - Coordinate with Zoo major planning updates
 - Reduce vehicular / pedestrian conflicts at entry
 - Continue to incorporate green infrastructure at Zoo parking
 - Strengthen bike and pedestrian links through Brookside Park to Zoo entrances

- PEARL ROAD GATEWAY**
- See Area Plan highlighting gateway to Zoo and Brookside Park and incorporating Foote Wolf Memorial Park, . 56 acres added in 2023, and updates to Zoo signage
 - Improve access and sightlines into the park
 - Explore bus drop off / Zoo shuttle to improve transit access

- VALLEY WALLS**
- Repair damaged headwalls
 - Add plantings and stabilize erosion
 - Develop natural surface trail from Wildlife Way to E.38th

- BRIGHTON PARK**
- Consider adding a small scale nature play feature
 - The Greater Cleveland Regional Transit Authority's MetroHealth Bus Rapid Transit improvements will add a two-stage mid-block crosswalk for safe connections between the zoo and Brighton Park

- CONNECTIONS TO EAST**
- Add wayfinding and promote Brighton Park, neighborhood greenway, and Treadway Creek trails as a connection to the Towpath, including missing link at Jennings Road
 - Coordinate repairs along Treadway Creek trail with City of Cleveland

All Purpose Trail

Other CM Trails

Proposed Trails (Various Entities)

Land Protection

Water

Wetlands

Other Parks

Brookside Reservation: 176 acres



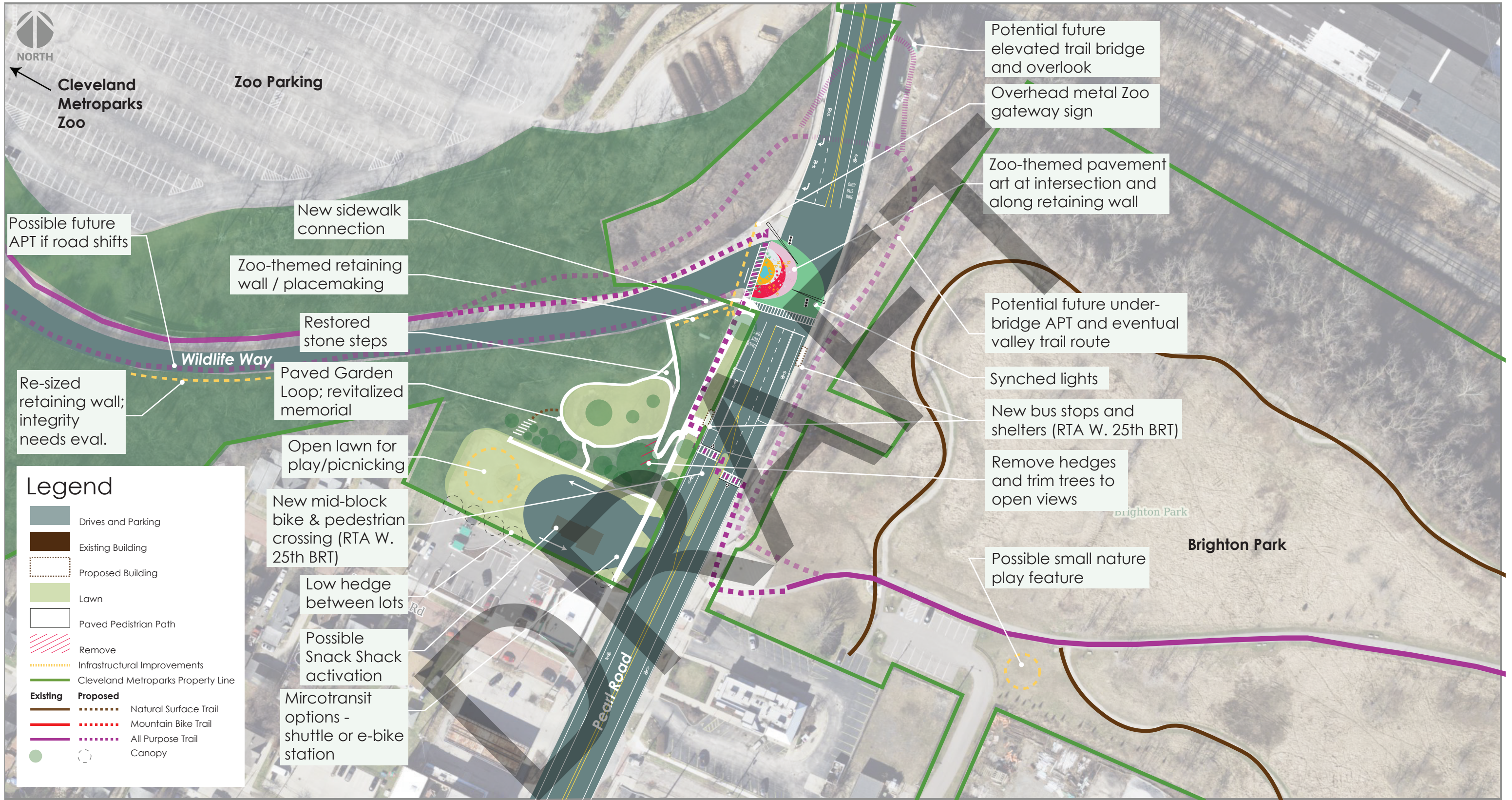

Pearl Road Gateway / Foote Wolfe Memorial Concept

September 2025

